

Mounting the G-tech

The G-tech is shipped with a sophisticated mounting system that is used to hold the G-tech steady in your vehicle.

This section describes:

- the different pieces of the mounting bracket
- how to assemble the mounting bracket
- how to mount the bracket in your vehicle

Note: *In order to obtain accurate measurements, the G-tech must be mounted properly. Please read this section carefully, it is very important!*

For directions on removing the mounting bracket from your windshield, please refer to “Removing the bracket” on page 150.

For directions on permanently mounting the bracket in your vehicle, please refer to “Permanent Mounting” on page 151.

Figure 9 shows the different pieces of the G-tech mounting bracket.

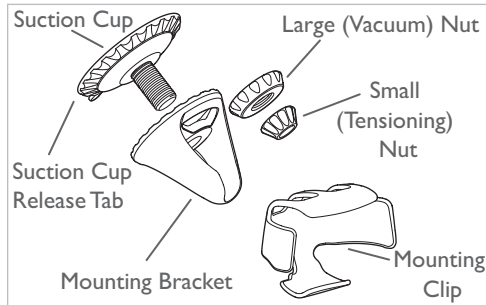
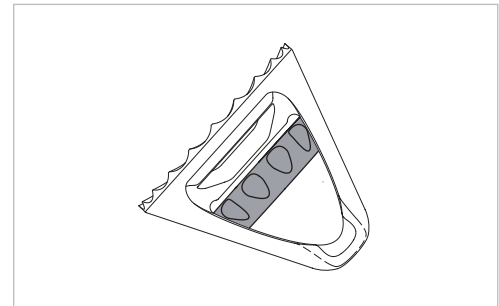

Figure 9: Mounting bracket parts

Assembling the Bracket

Note: Steps 1-3 may already be performed on your mounting bracket at the factory. These steps are provided so that you can always properly re-assemble your mounting bracket from its pieces if necessary.

Insert the Large Vacuum Nut into the Mounting Bracket.



- 2** Insert the suction cup into the mounting bracket.

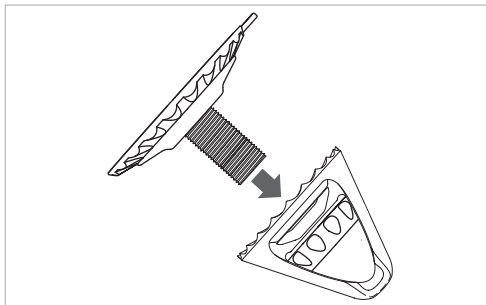

- 3** Turn the suction cup clockwise into the Large Vacuum Nut until approximately 1/4 inch of threads protrude.

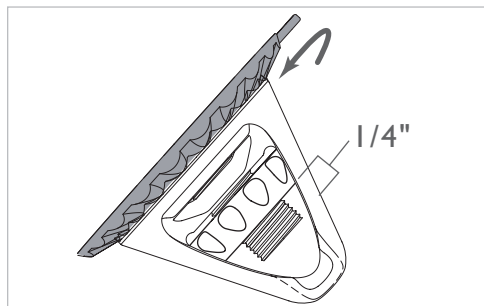

4

Place the Small Tensioning Nut on the threaded spindle, and turn it clockwise until it is snug on the stem. There should be a small gap between the Small Tensioning Nut and the Large Vacuum Nut.

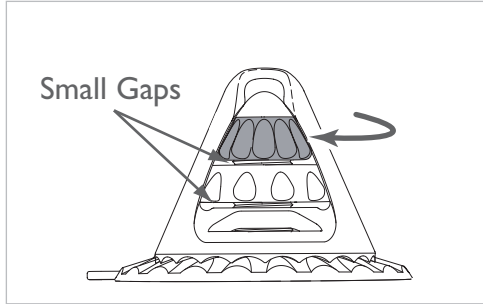

5

Now back off the Large Vacuum Nut counter-clockwise until it touches the Small Tensioning Nut.

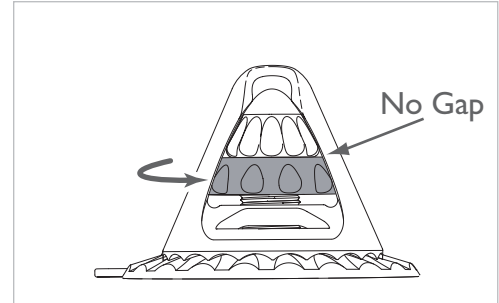

6

Gently insert the rubber ball of the mounting clip into the mounting bracket. It should go in with little force and fit snugly.



Mounting the Bracket

1

Find a place on your vehicle's windshield where you can mount the G-tech without affecting visibility.

Note: *Make sure the mounting area on the windshield is very clean and dry; otherwise, the mounting bracket may not work properly.*

2

Place the large rubber suction cup on the mounting area of the windshield. Make sure there is a large gap between the Large Vacuum Nut and the mounting bracket.

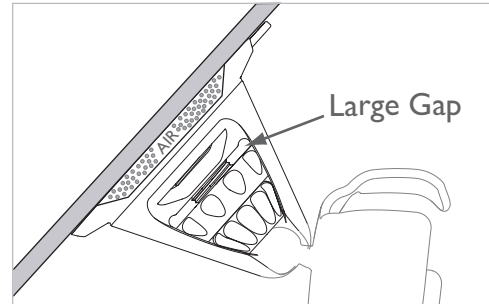

3

Push the Large Vacuum Nut firmly towards the windshield to expel all air between the suction cup and the windshield. **This is a very important step to ensure proper operation of the mounting system.**

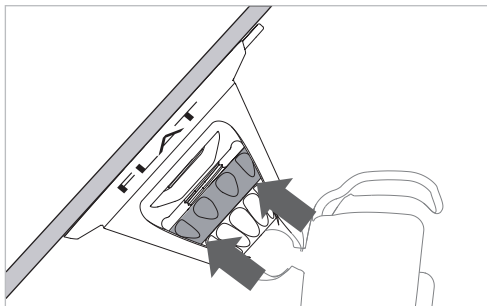

4

At this point, the mounting bracket should stay attached to the windshield when you remove your hands. If it doesn't, inspect the rubber suction cup for cracks or tears, and make sure the windshield surface is clean.

5

Turn the Large Vacuum Nut clockwise in order to create a vacuum between the suction cup and the windshield. **Be sure to turn the Large Vacuum Nut as far as possible.**

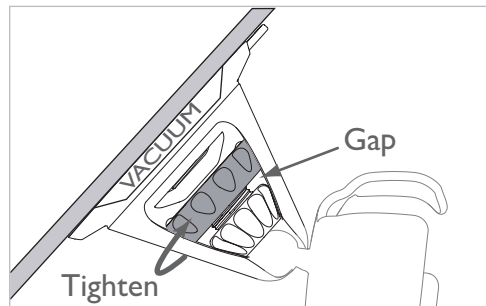

6

The mounting clip should be steady and should not move easily. If this is not the case, slowly turn the Small Tensioning Nut counter-clockwise just enough to secure the mounting clip.

Note: You should only need to use the Small Tensioning Nut for fine adjustments the first time you mount the G-tech. After the initial mounting, you would secure the clip by turning the Large Vacuum Nut clockwise to tighten it.

Note: The clip should be completely rigid. A G-tech which slips during a run will lead to inaccurate results.

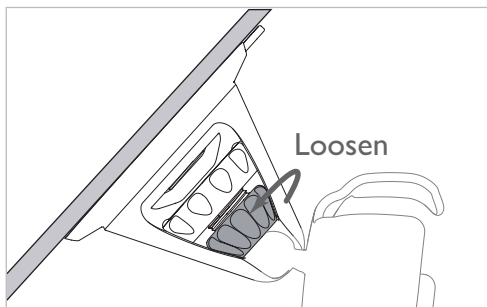

7

Insert the small end of the power cord into the DC jack, which is located on the back of the G-tech.

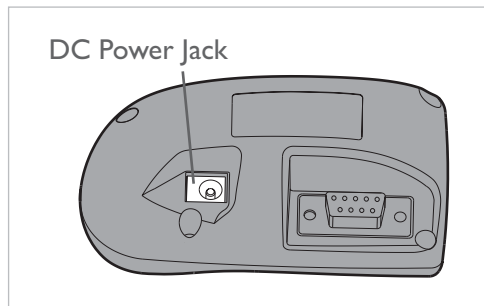

8

Snap the G-tech into the mounting clip.

Note: Do not move the mounting clip if you need to adjust the orientation of the G-tech! This will damage your mounting system and will not be covered under warranty.

To safely re-orient the mounting clip for easier viewing, please refer to “Adjusting the bracket” on page 149.

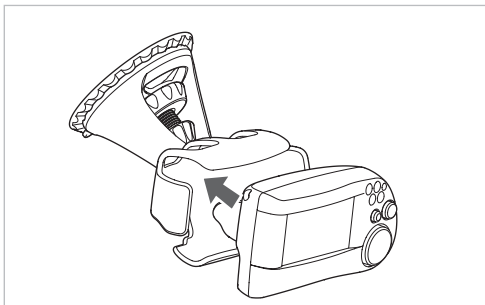

9

Plug the large end of the power cord into your vehicle's 12V cigarette lighter socket. The G-tech will power on.

Note: Some vehicles supply power to the 12V socket only when the ignition is in the ACCESSORY position or when the vehicle is running.

Note: The G-tech does not have an ON/OFF switch. Please be sure to unplug the G-tech when exiting your vehicle so as to not drain your vehicle's battery.

Adjusting the bracket

This section describes how to adjust the position of the mounting clip for better viewing.

It is very important that this technique be followed in order to avoid damage to your mounting system.

- Turn the Large Vacuum Nut *counter-clockwise* until the mounting clip can rotate freely.

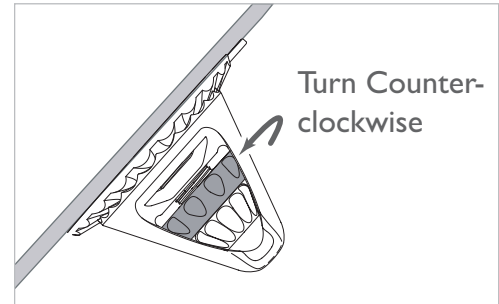

2 Adjust the position of the mounting clip gently. If the clip does not pivot easily, loosen the Large Vacuum Nut even more, otherwise you risk damaging the ball portion of the mounting clip.

3 Turn the Large Vacuum Nut *clockwise* until it is snug and the mounting clip is held firmly in place.

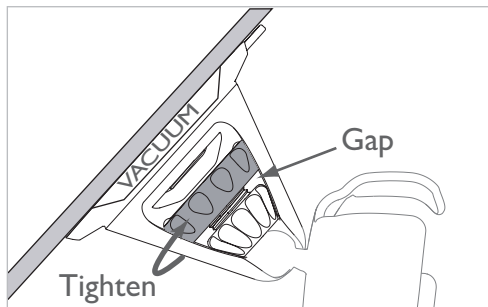

Removing the bracket

It is very important that this technique be followed in order to avoid damage to your mounting system.

Turn the Large Vacuum Nut *counter-clockwise* until it is snug up against the Small Tensioning Nut.

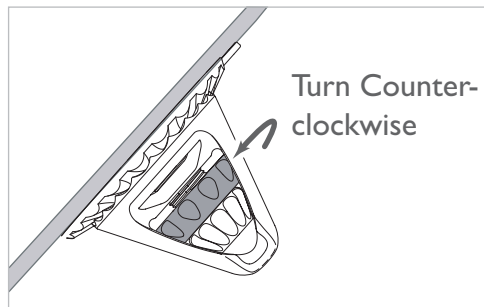

2

Find the small rubber tab protruding from the side of the large rubber suction cup that is attached to the windshield.

Pull the rubber tab gently away from the windshield. This should break the vacuum seal and the entire mounting apparatus should come off easily.

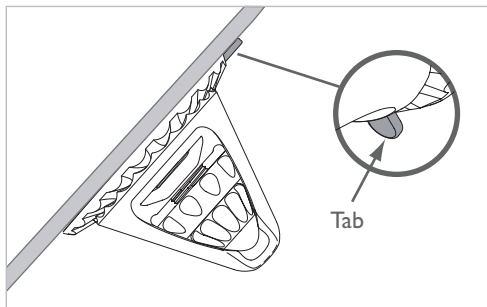

Permanent Mounting

Your G-tech is supplied with a permanent mounting stem (Figure 46) which can be attached to a part of your vehicle other than the windshield.

Note: To use the permanent mounting system, holes must be drilled on a relatively flat surface within the vehicle.

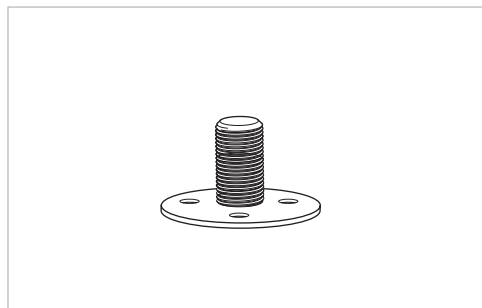

Figure 46: Permanent Mounting Stem

Use the provided screws to mount the permanent mounting stem in your vehicle. Re-assemble the mounting bracket as shown in page 37. Remember not to overtighten.